

HYDRAULIK-GELENKKOPF klemmbar DIN ISO 8132

Gleitpaarung: Stahl/Stahl >> wartungspflichtig GIHN-K ... LO

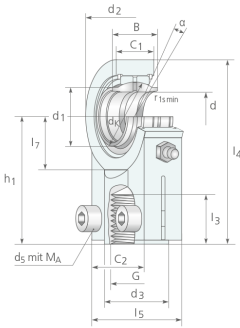

Lagerluftgruppen [µm] GIHN-K ... LO

d [mm]	CN
12	23 bis 68
12 ≤ d ≤ 20	30 bis 82
20 < d ≤ 32	37 bis 100
32 < d ≤ 50	43 bis 120
50 < d ≤ 90	55 bis 142
90 < d ≤ 125	65 bis 165
125 < d ≤ 200	65 bis 192

- Bezeichnung für Linksgewinde: GIHNL-K ... LO
 - Weitere Abmessungen auf Anfrage

Einbaubedingungen GIHN-K ... LO

Material	Gültig für Wellen-Ø	Oberflächenqualität	Einbaupassung bei Lagerluftgruppe		
			C2	CN	C3
Welle aus Stahl	12 ≤ d ≤ 320 mm	≤ Rz 10	j6	m6	m6

Grenzmaße der Kantenbrüche [mm] GIHN-K ... LO

d [mm]	12 ≤ d ≤ 20	20 < d ≤ 50	50 < d ≤ 160	160 < d ≤ 200
r 1s min [mm]	0,3	0,6	1,0	1,1

	d	B	C1	dK	??	m	C	C0	? d1	G	d2	d3	h1	l3 min	l4 max	l5 max	l7 min	C2	d5 1)	MA	
			max								max	max						max			
	[mm]	[mm]	[mm]	[mm]	[°]	[kg]	[kN]	[kN]	[mm]	[-]	[mm]	[mm]	[mm]	[mm]	[mm]	[mm]	[mm]	[mm]	[mm]	[-]	[Nm]
GIHN-K 12 LO*)	12	12	11	18,0	4	0,10	10,8	24,5	15,5	M 12 x 1,25	33	17,0	38	17	55,5	32	14	10,0	5â??xâ??	6	
GIHN-K 16 LO	16	16	13	23,0	4	0,21	17,6	36,5	20,0	M 14 x 1,5	32	22,5	44	19	64,5	40	18	13,0	6â??xâ??	10	
GIHN-K 20 LO	20	20	17	29,0	4	0,35	30,0	48,0	25,0	M 16 x 1,5	40	26,5	52	23	77,5	47	22	17,0	8â??xâ??	25	
GIHN-K 25 LO	25	25	21	35,5	4	0,65	48,0	78,0	30,5	M 20 x 1,5	47	32,0	65	29	97,0	54	27	17,0	8â??xâ??	25	
GIHN-K 32 LO	32	32	27	44,0	4	1,20	67,0	114,0	38,0	M 27 x 2,0	58	40,0	80	37	120,0	66	32	22,0	10â??xâ??	49	
GIHN-K 40 LO	40	40	32	53,0	4	2,00	100,0	204,0	46,0	M 33 x 2,0	70	49,0	97	46	147,0	80	41	26,0	10â??xâ??	49	
GIHN-K 50 LO	50	50	40	66,0	4	3,75	156,0	310,0	57,0	M 42 x 2,0	89	60,5	120	57	181,0	96	50	32,0	12â??xâ??	86	
GIHN-K 63 LO	63	63	52	83,0	4	7,25	255,0	430,0	71,5	M 48 x 2,0	108	72,5	140	64	213,0	114	62	38,0	16â??xâ??	210	
GIHN-K 70 LO	70	70	57	92,0	4	11,05	315,0	540,0	79,0	M 56 x 2,0	132	83,0	160	76	247,0	135	70	42,0	16â??xâ??	210	
GIHN-K 80 LO	80	80	66	105,0	4	15,15	400,0	605,0	91,0	M 64 x 3,0	155	93,0	180	86	272,0	148	78	48,0	20â??xâ??	410	
GIHN-K 90 LO	90	90	72	115,0	4	19,70	490,0	750,0	99,0	M 72 x 3,0	168	103,5	195	91	298,0	160	85	52,0	20â??xâ??	410	
GIHN-K 100 LO	100	100	84	130,0	4	25,50	610,0	1060,0	113,0	M 80 x 3,0	185	114,0	210	96	324,0	178	98	62,0	24â??xâ??	710	
GIHN-K 110 LO	110	110	88	140,0	4	32,50	655,0	1200,0	124,0	M 90 x 3,0	210	129,0	235	106	366,0	190	105	62,0	24â??xâ??	710	
GIHN-K 125 LO	125	125	102	160,0	4	46,00	950,0	1430,0	138,0	M 100 x 3,0	262	139,0	260	113	407,0	200	120	72,0	24â??xâ??	710	
GIHN-K 160 LO	160	160	130	200,0	4	82,50	1370,0	2200,0	177,0	M 125 x 4,0	326	170,0	310	126	490,0	250	150	82,0	24â??xâ??	710	
GIHN-K 200 LO	200	200	162	250,0	4	168,00	2120,0	3650,0	221,0	M 160 x 4,0	418	221,0	390	161	623,0	320	195	102,0	30â??xâ??	1500	

