

# GELENKKOPF DIN ISO 12240-4 Maßreihe E

## Gleitpaarung: Hartchrom/PTFE-Verbund >> wartungsfrei EA ... D

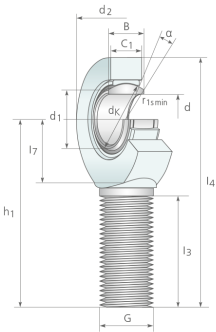

Lagerluftgruppen [µm] EA ... D

| d [mm]      | CN       |
|-------------|----------|
| 6 < d ≤ 12  | 0 bis 32 |
| 12 < d ≤ 20 | 0 bis 40 |
| 20 < d ≤ 30 | 0 bis 50 |

- Kurzbezeichnungen erfolgen in Anlehnung an DIN ISO 12240  
 - Bezeichnung für Linksgewinde: EAL ... D  
 - Weitere Abmessungen auf Anfrage

Einbaubedingungen EA ... D

| Material        | Gültig für Wellen-Ø | Oberflächenqualität | Einbaupassung bei Lagerluftgruppe CN |
|-----------------|---------------------|---------------------|--------------------------------------|
| Welle aus Stahl | d ≤ 80 mm           | ≤ Rz 10             | j6                                   |

Grenzmaße der Kantenbrüche [mm] EA ... D

| d [mm]        | 6 < d ≤ 20 | 20 < d ≤ 30 |
|---------------|------------|-------------|
| r 15 min [mm] | 0,3        | 0,6         |

|         | d    | B    | C1   | dK   | ??  | m     | C     | C0     | ? d1 | G           | d2   | h1   | l3 min | l4 max | l7 min |
|---------|------|------|------|------|-----|-------|-------|--------|------|-------------|------|------|--------|--------|--------|
|         |      |      | max  |      |     |       |       |        |      |             | max  |      |        |        |        |
|         | [mm] | [mm] | [mm] | [mm] | [°] | [kg]  | [kN]  | [kN]   | [mm] | [mm]        | [mm] | [mm] | [mm]   | [mm]   | [mm]   |
| EA 15 D | 15   | 12   | 10,0 | 22,0 | 8   | 0,140 | 17,60 | 36,00  | 18   | M 14 x 2,0  | 40   | 61   | 34     | 83     | 20     |
| EA 6 D  | 6    | 6    | 4,4  | 10,0 | 13  | 0,018 | 3,60  | 8,15   | 8    | M 6 x 1,0   | 21   | 30   | 18     | 46     | 12     |
| EA 17 D | 17   | 14   | 11,0 | 25,0 | 10  | 0,190 | 22,40 | 45,00  | 21   | M 16 x 2,0  | 46   | 67   | 36     | 92     | 23     |
| EA 8 D  | 8    | 8    | 6,0  | 13,0 | 15  | 0,030 | 5,85  | 12,90  | 10   | M 8 x 1,25  | 24   | 36   | 22     | 54     | 14     |
| EA 12 D | 12   | 10   | 8,0  | 18,0 | 11  | 0,086 | 11,40 | 24,50  | 15   | M 12 x 1,75 | 34   | 50   | 28     | 71     | 18     |
| EA 25 D | 25   | 20   | 17,0 | 35,5 | 7   | 0,600 | 51,00 | 83,00  | 29   | M 24 x 2,0  | 64   | 94   | 53     | 126    | 32     |
| EA 20 D | 20   | 16   | 13,0 | 29,0 | 9   | 0,310 | 31,50 | 60,00  | 24   | M 20 x 1,5  | 53   | 77   | 43     | 104    | 27     |
| EA 30 D | 30   | 22   | 19,0 | 40,7 | 6   | 0,890 | 66,50 | 110,00 | 34   | M 30 x 2,0  | 73   | 110  | 65     | 181    | 37     |
| EA 10 D | 10   | 9    | 7,0  | 16,0 | 12  | 0,054 | 8,65  | 17,60  | 13   | M 10 x 1,5  | 29   | 43   | 26     | 62     | 15     |

