

UCS 201 ... UCS 328 RILLENKUGELLAGER (ZYLINDRISCHER AUßENRING)

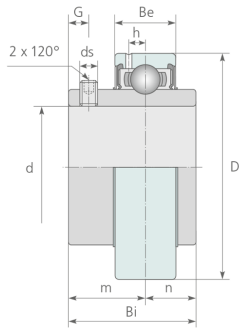

| | Abmessungen [mm] | | | | | | | | | Tragzahl [kN] | | Gewicht |
|---------|------------------|-----|------|----|------|------|------|-----|------------|---------------|---------|---------|
| | d[mm] | D | Bi | Be | n | m | G | h | ds | dyn.C | stat.C0 | [kg] |
| UCS 201 | 12 | 47 | 31,0 | 17 | 12,7 | 18,3 | 4,8 | 3,5 | M6 x 1,0 | 12,8 | 6,7 | 0,21 |
| UCS 202 | 15 | 47 | 31,0 | 17 | 12,7 | 18,3 | 4,8 | 3,5 | M6 x 1,0 | 12,8 | 6,7 | 0,19 |
| UCS 203 | 17 | 47 | 31,0 | 17 | 12,7 | 18,3 | 4,8 | 3,5 | M6 x 1,0 | 12,8 | 6,7 | 0,18 |
| UCS 204 | 20 | 47 | 31,0 | 17 | 12,7 | 18,3 | 4,8 | 4,4 | M6 x 1,0 | 12,8 | 6,7 | 0,16 |
| UCS 205 | 25 | 52 | 34,0 | 17 | 14,3 | 19,7 | 5,5 | 4,3 | M6 x 1,0 | 14,0 | 7,9 | 0,20 |
| UCS 305 | 25 | 62 | 38,0 | 22 | 15,0 | 23,0 | 6,0 | 6,2 | M6 x 1,0 | 20,6 | 11,3 | 0,45 |
| UCS 206 | 30 | 62 | 38,1 | 19 | 15,9 | 22,2 | 6,0 | 5,0 | M6 x 1,0 | 19,5 | 11,3 | 0,32 |
| UCS 306 | 30 | 72 | 43,0 | 24 | 17,0 | 26,0 | 8,0 | 6,5 | M6 x 1,0 | 29,9 | 15,8 | 0,56 |
| UCS 207 | 35 | 72 | 42,9 | 20 | 17,5 | 25,4 | 6,5 | 5,8 | M8 x 1,0 | 25,7 | 15,4 | 0,48 |
| UCS 307 | 35 | 80 | 48,0 | 26 | 19,0 | 29,0 | 10,0 | 7,2 | M8 x 1,0 | 33,5 | 18,3 | 0,71 |
| UCS 208 | 40 | 80 | 49,2 | 21 | 19,0 | 30,2 | 8,0 | 6,3 | M8 x 1,0 | 32,0 | 17,8 | 0,62 |
| UCS 308 | 40 | 90 | 52,0 | 28 | 19,0 | 33,0 | 10,0 | 8,5 | M10 x 1,25 | 40,7 | 24,0 | 1,00 |
| UCS 209 | 45 | 85 | 49,2 | 22 | 19,0 | 30,2 | 8,0 | 6,8 | M8 x 1,0 | 32,7 | 20,2 | 0,68 |
| UCS 309 | 45 | 100 | 57,0 | 30 | 22,0 | 35,0 | 10,0 | 9,0 | M10 x 1,25 | 52,7 | 31,7 | 1,33 |
| UCS 210 | 50 | 90 | 51,6 | 24 | 19,0 | 32,6 | 10,0 | 6,5 | M10 x 1,0 | 35,1 | 23,1 | 0,79 |

UCS 201 ... UCS 328 RILLENKUGELLAGER (ZYLINDRISCHER AUßENRING)

| | Abmessungen [mm] | | | | | | | | | Tragzahl [kN] | | Gewicht |
|---------|------------------|-----|-------|----|------|------|------|------|-----------|---------------|---------|---------|
| | d[mm] | D | Bi | Be | n | m | G | h | ds | dyn.C | stat.C0 | [kg] |
| UCS 310 | 50 | 110 | 61,0 | 32 | 22,0 | 39,0 | 12,0 | 9,9 | M12 x 1,5 | 62,0 | 37,9 | 1,72 |
| UCS 211 | 55 | 100 | 55,6 | 25 | 22,2 | 33,4 | 10,0 | 7,2 | M10 x 1,0 | 43,6 | 29,3 | 1,01 |
| UCS 311 | 55 | 120 | 66,0 | 34 | 25,0 | 41,0 | 12,0 | 10,6 | M12 x 1,5 | 71,5 | 44,6 | 1,90 |
| UCS 212 | 60 | 110 | 65,1 | 27 | 25,4 | 39,7 | 10,0 | 8,2 | M10 x 1,0 | 52,4 | 36,0 | 1,45 |
| UCS 312 | 60 | 130 | 71,0 | 36 | 26,0 | 45,0 | 12,0 | 11,3 | M12 x 1,5 | 81,5 | 51,9 | 2,60 |
| UCS 213 | 65 | 120 | 65,1 | 28 | 25,4 | 39,7 | 10,0 | 8,0 | M10 x 1,0 | 57,2 | 40,0 | 1,80 |
| UCS 313 | 65 | 140 | 75,0 | 38 | 30,0 | 45,0 | 12,0 | 12,5 | M12 x 1,5 | 93,0 | 59,7 | 3,16 |
| UCS 214 | 70 | 125 | 74,6 | 30 | 30,2 | 44,4 | 12,0 | 9,0 | M12 x 1,5 | 62,2 | 44,1 | 1,99 |
| UCS 314 | 70 | 150 | 78,0 | 40 | 33,0 | 45,0 | 12,0 | 13,2 | M12 x 1,5 | 104,0 | 68,1 | 3,90 |
| UCS 215 | 75 | 130 | 77,8 | 30 | 33,3 | 44,5 | 12,0 | 9,0 | M12 x 1,5 | 67,4 | 49,3 | 2,19 |
| UCS 315 | 75 | 160 | 82,0 | 42 | 32,0 | 50,0 | 14,0 | 13,0 | M14 x 1,5 | 114,0 | 77,0 | 4,70 |
| UCS 216 | 80 | 140 | 82,6 | 33 | 33,3 | 49,3 | 14,0 | 10,3 | M12 x 1,5 | 72,7 | 53,0 | 2,72 |
| UCS 316 | 80 | 170 | 86,0 | 44 | 34,0 | 52,0 | 14,0 | 13,8 | M14 x 1,5 | 122,0 | 86,5 | 5,60 |
| UCS 217 | 85 | 150 | 85,7 | 35 | 34,1 | 51,6 | 14,0 | 11,0 | M12 x 1,5 | 83,2 | 61,9 | 3,45 |
| UCS 317 | 85 | 180 | 96,0 | 46 | 40,0 | 56,0 | 16,0 | 14,8 | M16 x 1,5 | 133,0 | 96,6 | 6,90 |
| UCS 218 | 90 | 160 | 96,0 | 37 | 39,7 | 56,3 | 14,0 | 12,0 | M12 x 1,5 | 95,6 | 71,5 | 4,35 |
| UCS 318 | 90 | 190 | 96,0 | 48 | 40,0 | 56,0 | 16,0 | 15,5 | M16 x 1,5 | 143,0 | 107,0 | 7,87 |
| UCS 319 | 95 | 200 | 103,0 | 50 | 41,0 | 62,0 | 16,0 | 16,8 | M16 x 1,5 | 153,0 | 118,0 | 8,91 |
| UCS 320 | 100 | 215 | 108,0 | 54 | 42,0 | 66,0 | 18,0 | 17,8 | M18 x 1,5 | 173,0 | 140,0 | 11,20 |
| UCS 322 | 110 | 240 | 117,0 | 60 | 46,0 | 71,0 | 20,0 | 20,6 | M18 x 1,5 | 203,0 | 178,0 | 15,10 |
| UCS 324 | 120 | 260 | 126,0 | 64 | 51,0 | 75,0 | 20,0 | 21,6 | M18 x 1,5 | 212,0 | 190,0 | 19,00 |
| UCS 326 | 130 | 280 | 135,0 | 68 | 54,0 | 81,0 | 20,0 | 22,6 | M20 x 1,5 | 229,0 | 214,0 | 23,60 |

UCS 201 ... UCS 328 RILLENKUGELLAGER (ZYLINDRISCHER AUßENRING)

| | Abmessungen [mm] | | | | | | | | | Tragzahl [kN] | | Gewicht |
|---------|------------------|-----|-------|----|------|------|------|------|-----------|---------------|---------|---------|
| | d[mm] | D | Bi | Be | n | m | G | h | ds | dyn.C | stat.C0 | [kg] |
| UCS 328 | 140 | 300 | 145,0 | 72 | 59,0 | 86,0 | 20,0 | 25,1 | M20 x 1,5 | 255,0 | 246,0 | 29,40 |